

This drawing is the property of General Electric. It is loaned to you for your use only. It is not to be distributed outside your organization. It is not to be used for the production of any other product without the written consent of General Electric.

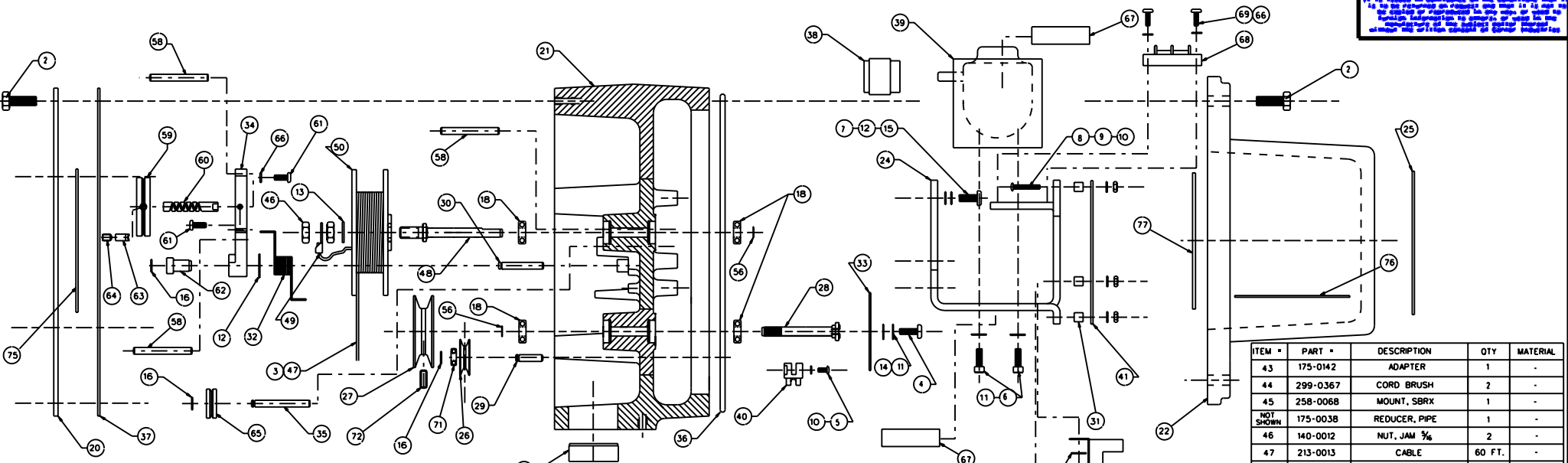

ITEM #	PART #	DESCRIPTION	QTY	MATERIAL
1	105-0022	1/4-20x1 SS	3	-
2	110-0048	1/4-20X3/4 SS	14	-
3	165-0018	OVAL SLEEVE	3	-
4	110-0013	8-32X5/16 SS	1	-
5	110-0019	4-40X3/8 SS	2	-
6	105-0103	8-32X1/2 SS	6	-
7	110-0078	10-24X1/2 SS	4	-
8	110-0080	4-40X3/4 SS	4	-
9	140-0022	HEX NUT 4-40	4	-
10	145-0002	WSHR FLT *4	4	-
11	145-0004	WSHR FLT *8	7	-
12	145-0005	WSHR FLT *10	5	-
13	145-0007	WASHER	1	-
14	145-1008	WSHR LK *8	1	-
15	145-1016	WSHR LK *10	5	-
16	165-0014	E RING 3/16	3	-
NOT SHOWN	175-0039	PLUG 1/8 NPT	1	-
18	200-1007	BRNG .25 ID	4	-
19	212-0012	SMB BOB	1	-
20	220-0224	COVER	1	-
21	220-0225	ENCLOSURE	1	-
22	220-0226	ENCL CAP	1	-

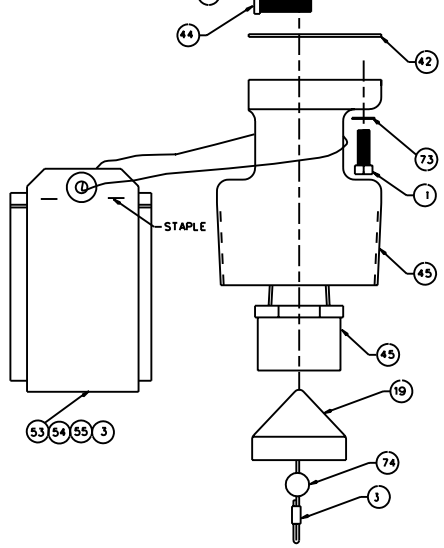

ITEM #	PART #	DESCRIPTION	QTY	MATERIAL
23	245-0024	CBL GUIDE	1	-
24	258-0067	MOTOR/PC MNT	1	-
25	260-0052	NAMEPLATE	1	-
26	272-0076	PULLEY .641 DA	2	-
27	272-0062	PULLEY TMNG	1	-
28	285-0068	SHFT TMNG	1	-
29	285-0069	SHFT IDLR .75	1	-
30	285-0071	SHFT IDLR 1.25	1	-
31	290-0047	SPCR NYLON 1/4	4	-
32	292-0027	TOR SPRING	1	-
33	299-0331	TMNG WHEEL	1	-
34	205-0178	BRACKET, LINE LEVELER	1	-
35	285-0089	SHFT IDLR .1875 X 1.63	1	-
36	280-0024	O RING .138	1	-
37	280-0025	GASKET COVER	1	-
38	299-0369	SLIP CLUTCH	1	-
39	530-0096	MOTOR 24 VDC	1	-
40	530-0095	OPTO SENSOR	1	-
41	530-0091	PCB ASSY	1	-
42	280-0026	GASKET	1	-

ITEM #	PART #	DESCRIPTION	QTY	MATERIAL
43	175-0142	ADAPTER	1	-
44	299-0367	CORD BRUSH	2	-
45	258-0068	MOUNT, SBXR	1	-
NOT SHOWN	175-0038	REDUCER, PIPE	1	-
46	140-0012	NUT, JAM 3/8	2	-
47	213-0013	CABLE	60 FT.	-
48	285-0067	SHAFT	1	-
49	318-0130	TERMINAL	1	-
50	272-0063	SPOOL	1	-
51	105-0018	SOC HEX *8-32 X .38	2	-
52	175-0079	CLAMP	1	-
53	255-0069	TAG	1	-
54	603-9012	PLASTIC BAG	1	-
55	927-0142	INSTRUCTION SHEET	1	-
56	165-0023	RING, RETAINING	2	-
57	299-0565	GUARD	1	-
58	150-0021	DOWEL .1875 X 1.63 LG.	3	-
59	272-0073	PULLEY, LINE LEVELER	1	-
60	285-0088	SHAFT, RECI PROCATING	1	-
61	110-0060	SCR PANHD 6-32 X .375	2	-
62	200-9028	BEARING, TENSIL ON ARM	1	-
63	299-0512	PANL, .25 DIA	1	-
64	115-0014	10-32 X 1/4 SET SCR	1	-
65	272-0074	PULLEY-.69 DIA. IDLER	1	-
66	145-1002	#6 LOCK WASHER	3	-
67	255-0105	LABEL- MOTOR MOUNTING	2	-
68	380-0052	TERMINAL BLOCK	1	-
69	110-0004	SCREW- #6-32	2	-
70	110-0077	SCREW- #10-24 X 3/8 SS	1	-
71	200-1001	BEARING- 3/8 DIA.	1	-
72	115-0004	SET SCWER 10-32	1	-
73	145-1007	WASHER, LOCK 1/4	3	-
74	299-0564	BUMPER	1	-
75	255-0048	LABEL	1	-
76	255-0112	LABEL	1	-
77	255-0049	LABEL	1	-

- NOTES:
1. ADD A SMALL AMOUNT OF LOCTITE 609 (P/N 614-0013) OR EQUIVALENT TO ITEM 23 BEFORE ASSEMBLY
 - 2.
 3. TIGHTEN ITEM 6 THEN LOOSEN 1/2 TURN
 4. CLEAN ITEMS #29, 30, 35 AND 58 WITH ALCOHOL. USING A 0-TIP. CLEAN RESPECTIVE CASTING HOLES WITH ALCOHOL. THEN DRY WITH CLEAN AIR. USING A 0-TIP. APPLY A SMALL AMOUNT OF LOCTITE #609 (P/N 614-0013) TO EACH PIN AND CASTING HOLE THEN ASSEMBLE AND WIPE CLEAN ANY EXCESS LOCTITE
 5. ASSEMBLE ITEMS 29, 30, 35 AND 58 INTO IT'S RESPECTIVE CASTING HOLE. THERE IS A 1/8 DEEP STARTER STEP IN EACH HOLE. THE PIN IS A TIGHT FIT. TAP PIN WITH HAMMER UNTIL PIN PENETRATES CASTING 1/8 THEN FINISH ASSEMBLY WITH A POWER PRESS.

DIMENSIONS ARE NOT ACCUMULATIVE

ECO-980811	SJS	9/13							
ECO-980604	SJS	6/9							
ECO-980302	SJS	7/8							
ECO-980206	SJS	7/8							
CHANGE AS PER	SJS	5/8							
ECO-980907	SJS	5/10							
ECO-980503	SJS	5/9							
ECO-210107	SJS	2/11							
ECO-990920	SJS	9/27							
ECO-990212	SJS	9/23							
ECO-981205	SJS	12/1							

DESIGNED BY	APPROVED BY	DATE
DRIVEN		
DESIGNED		
DESIGNED	SJS	4-11-95

4160193