



# BINMASTER

## QUICK SETUP GUIDE

BCGW.100.XXLLE

# BIN CLOUD GATEWAY

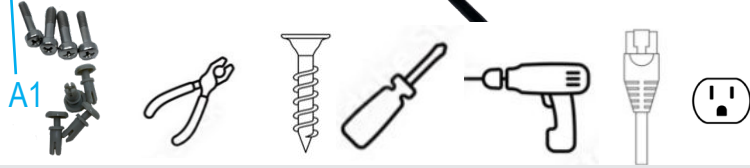

Tools needed: drill and bit, phillips screwdriver, drywall/ wood screws, ethernet cable, pliers. Screws and plastic plugs, A1, can be used to secure the top cover.

### STEP 1

Choose a location to mount your Gateway and the antenna. For the Gateway (pictured above), make sure there is access to a 120VAC outlet and, preferably, an ethernet connection. The antenna should be in a good line of site to sensors within 20 feet of the Gateway location.

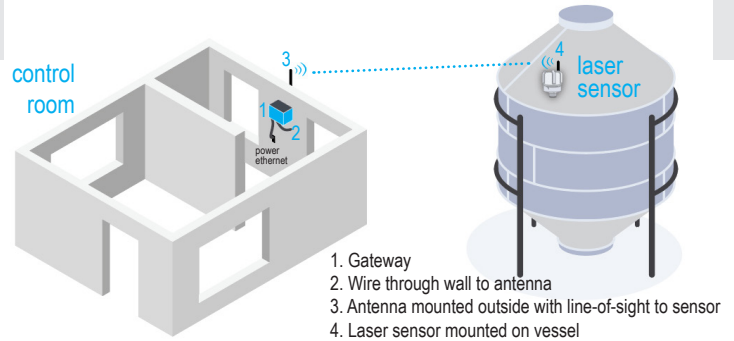

### STEP 2

Attach mount brackets to the enclosure with the included screws. Brackets fit on protruding screwholes on the back of the enclosure. Then, use drywall screws and attach unit to the wall location.

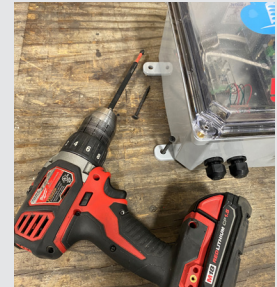

### STEP 3

Assemble the antenna with mounting hardware.

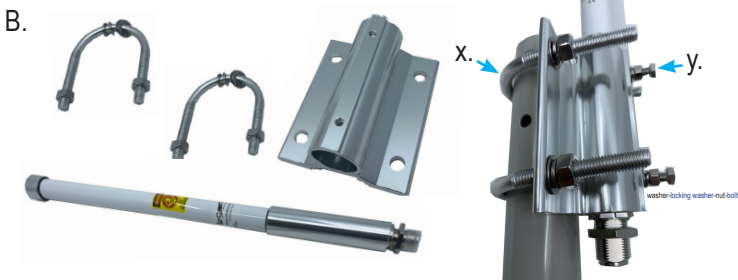
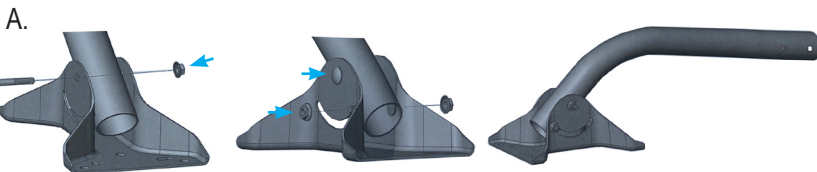

A. Attach the curved mount pipe to its base with the smooth bolt on top and two small bolts and nuts on the swivel bottom.

B. Using U-bolts as shown attach antenna mount to mount pipe (x). Then insert small screws on top of mount to hold antenna in place (y).

C. Mount the antenna outside, in a location (Step 1) within a good line-of-site to your sensor(s). Remember the cable between the Gateway unit and the antenna should be less than 20 feet or ask your BinMaster rep for an extension.



## STEP 4

- A. Connect antenna wire to the top of the Gateway unit.
  - B. Connect antenna wire to bottom of antenna.
  - C. Plug Gateway into a 120V outlet.
  - D. Connect the Gateway ethernet plug to a network port, router or switch.
- with your specific bins, tanks, silos, sizes, locations, etc. We'll chat about your page during the connection verification call.

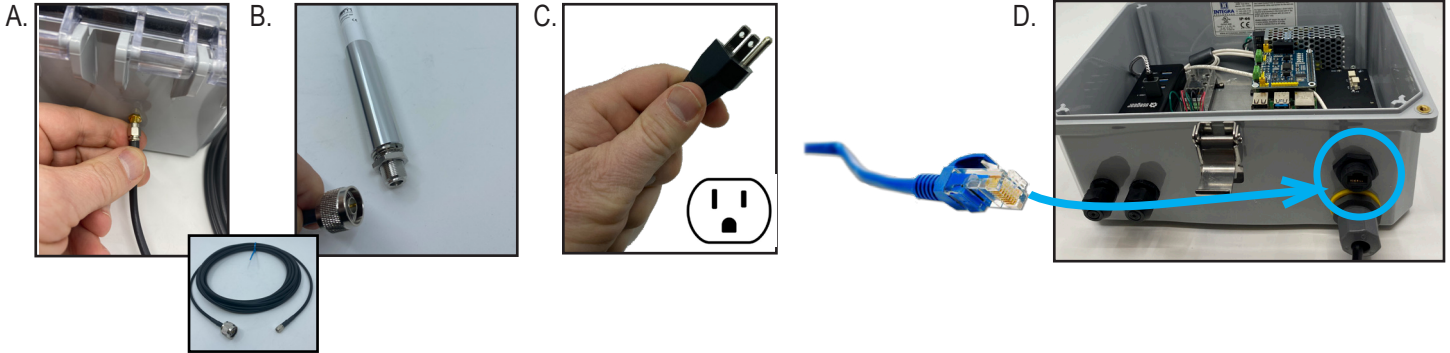

## WAY TO GO!

Wait 25 minutes and call BinMaster at 1-800-278-4241 to confirm the internet connection. BinMaster will create a custom cloud page using measurements from your bins, tanks, silos, etc. Check the worksheet on following pages so you can prepare for this conversation.

## FIREWALL RULES FOR BINCLOUD GATEWAY

Direction Outbound	Ports	For these IPS	IP Addresses
TCP	80, 433		All
UDP	5959-5961		52.38.107.102
	5959-5961		52.25.64.249
	5959-5961		34.221.219.221
	5959-5961		54.218.6.237
UDP	5959-5970		52.39.255.60
			54.71.174.229
			52.88.4.160
			34.217.159.41
			34.213.84.184
			52.43.176.61
			35.162.54.59
			52.42.122.172
			44.224.165.129
			44.226.176.44
			44.237.66.197
			44.238.4.218
			54.184.44.101
			44.228.115.25
			44.230.239.2
			44.236.20.68
			44.236.200.9
			44.236.76.190
			44.239.243.92
			44.240.35.27

Direction Outbound	Ports	Region	IP Addresses
UDP	20000-40000	USA	All
UDP			54.212.116.92
UDP			52.12.114.120
UDP			52.87.228.243
UDP			3.88.21.119
UDP			34.223.7.202
UDP		Europe	54.93.100.223
UDP			18.195.88.21
UDP			18.184.70.5
UDP		India	15.207.116.15
UDP			13.127.230.228
UDP		SE Asia	13.212.70.205
UDP			13.212.30.222
UDP		Asia	18.182.42.125
UDP			13.230.250.171
UDP			18.179.34.24
UDP		Japan	52.69.206.76
UDP			18.179.57.238

## Measuring a Vessel | Get Ready for BinCloud

In order to calculate material from level readings, we set up BinCloud software with your vessel dimensions. Bins, silos, and tanks vary greatly, so you'll need to provide physical measurements to BinMaster. Here's a handy guide to prepare for the BinMaster call:

Vessel Manufacturer \_\_\_\_\_ Model # \_\_\_\_\_ Other ID # \_\_\_\_\_  
(if available from paperwork or plate on vessel)

<p><b>Straight Wall Height:</b> _____</p> <p><b>Diameter*:</b> _____</p> <p><b>Width*:</b> _____</p> <p><b>Length*:</b> _____</p> <p><b>Top Cone Angle*:</b> _____</p> <p><b>Bottom Cone Angle*:</b> _____</p>	<p><b>Top Cone Height:</b> _____</p> <p><b>Bottom Cone Height:</b> _____</p> <p><b>Bottom Opening:</b> width: _____ length: _____</p> <p><b>Top Opening:</b> width: _____ length: _____</p> <p>Sensor Position _____</p> <p>Capacity _____</p>	<p><b>Sensors 4-20mA</b></p> <p>4mA Distance Setting (empty): _____</p> <p>20mA Distance Setting (full): _____</p> <p><small>Many measurements are available through vessel manuals and similar paperwork. Try searching model number and manufacturer name before pulling out your tape measure. * indicates this measurement needed only if applicable to the vessel shape (see illustration above)</small></p>
--	--	---

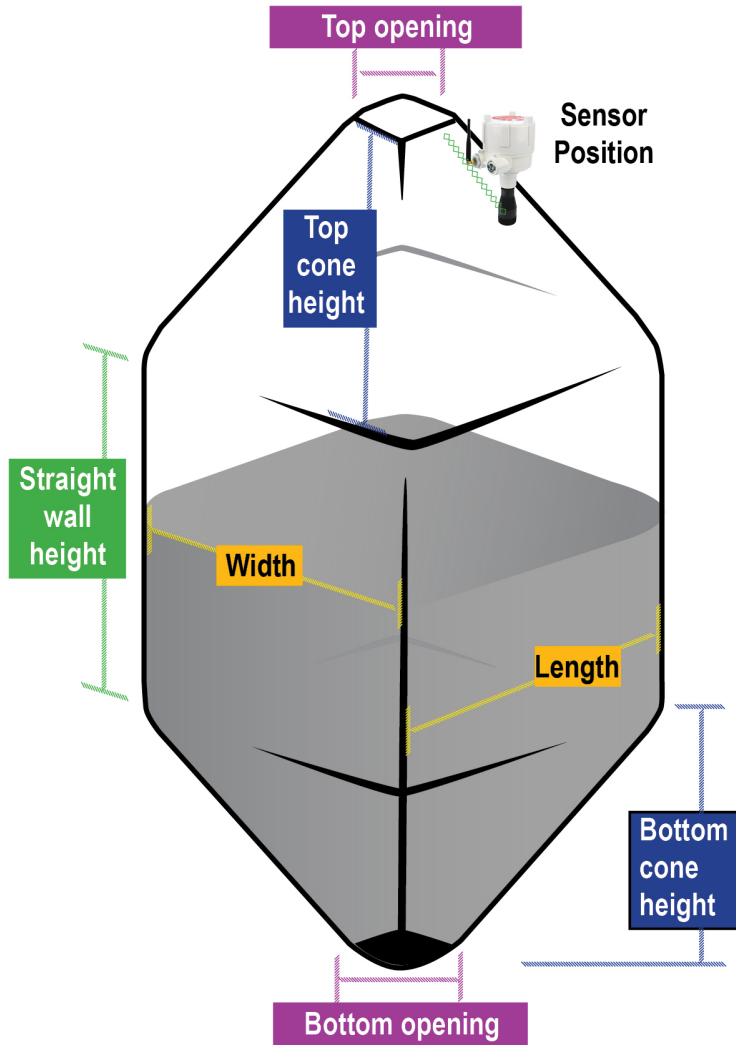
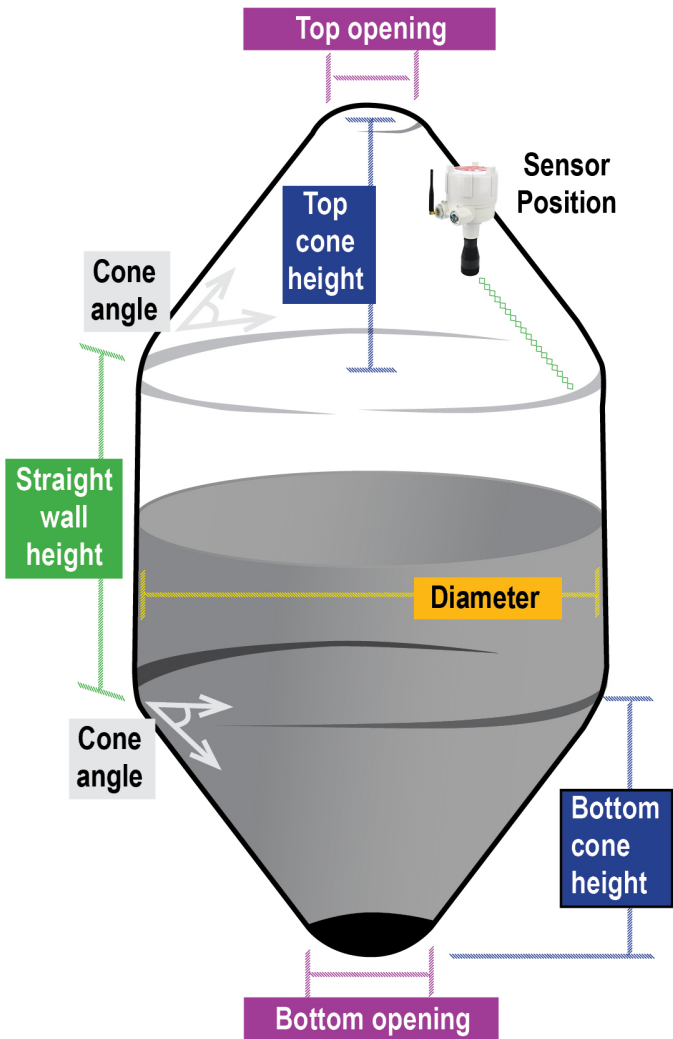

MORE CONFIGURATIONS →

## Measuring a Vessel | Get Ready for BinCloud

