

BINMASTER®

Taking Control . . . To A Higher Level

Swivel Socket Assembly Instructions

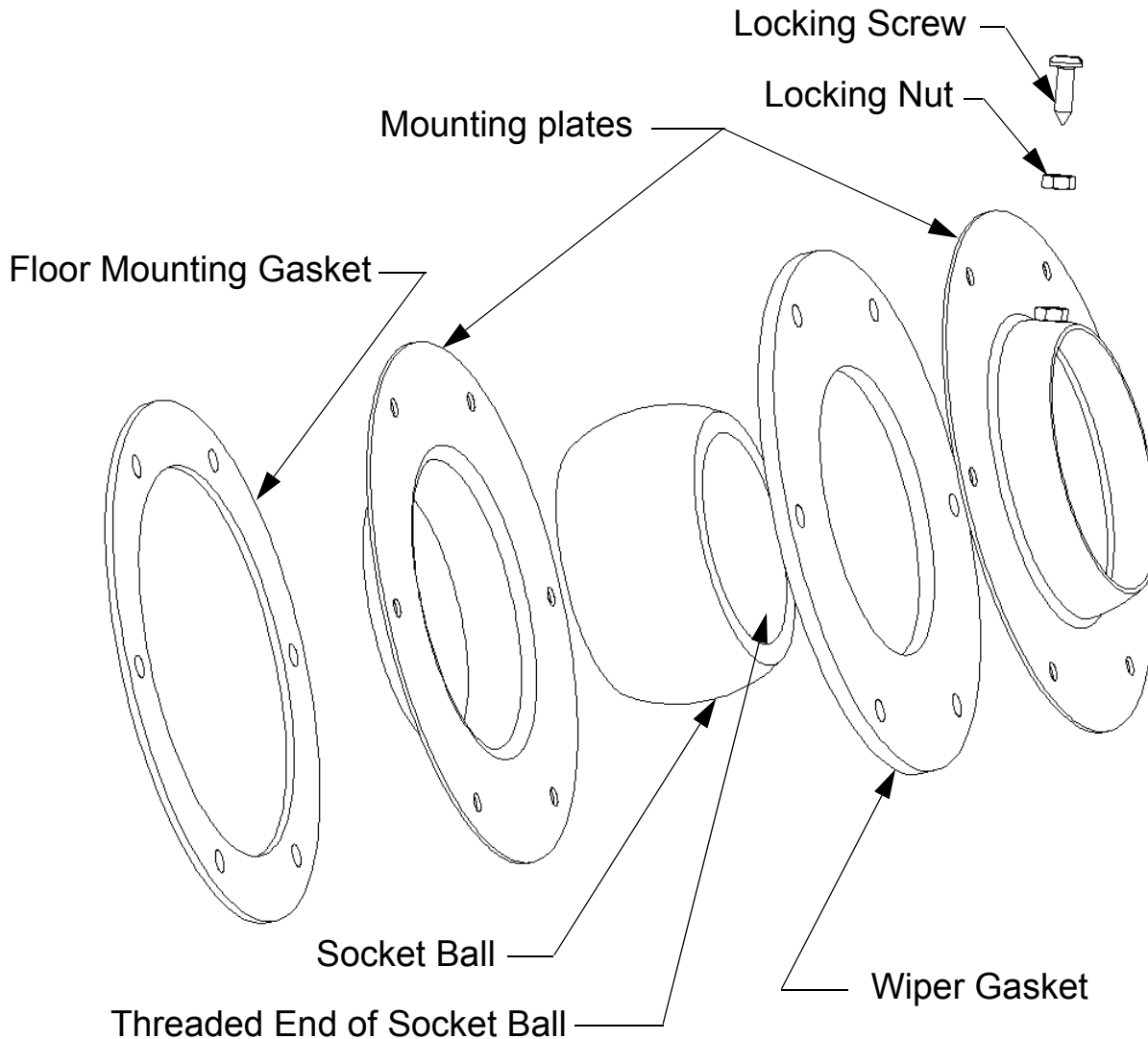

-
- Assemble swivel socket as shown above then bolt to vessel.
 - Assemble SmartSonic by screwing into the threaded end of the swivel ball.
 - Adjust desired angle.
 - Tighten screw (do not over tighten) and secure screw with lock nut.
-

BINMASTER®

Division of Garner Industries
7201 No. 98th Street P. O. Box 29709
Lincoln, NE 68507 Lincoln, NE 68529
(402) 434-9102 Fax (402) 434-9133
www.binmaster.com